

## Mode d'emploi

# COMBI

"L'électro-musculation intégrale"



- F** MODE D'EMPLOI
- GB** USER OPERATING INSTRUCTIONS
- D** ANWENDUNGSHINWEISE
- I** MANUALE CON LE ISTRUZIONI
- E** MANUAL DE INSTRUCCIONES
- EU** MĀKŠĪBAS VEĀROŠĀNĀS LIETOŠĀNĀS
- S** BRUKANISINĀJUMA
- P** MANUAŁ OPERACYJNY
- NL** HANDLEIDING

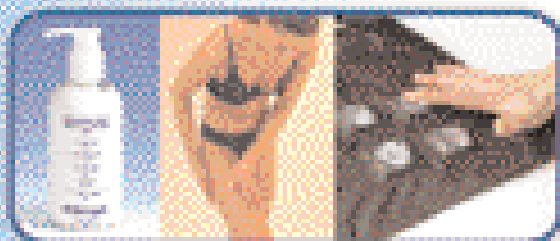

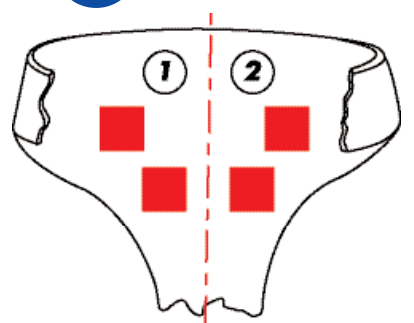
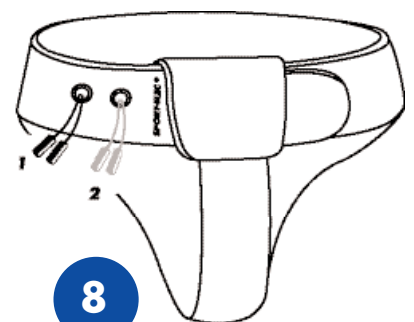
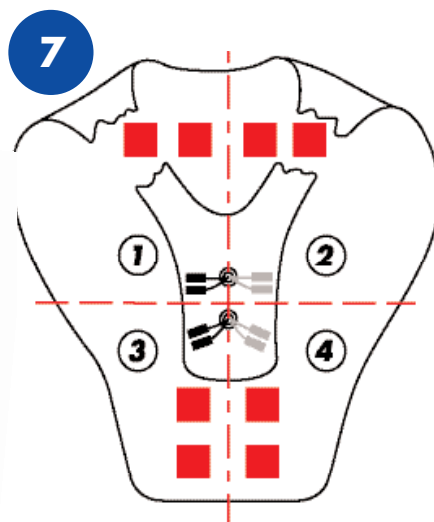
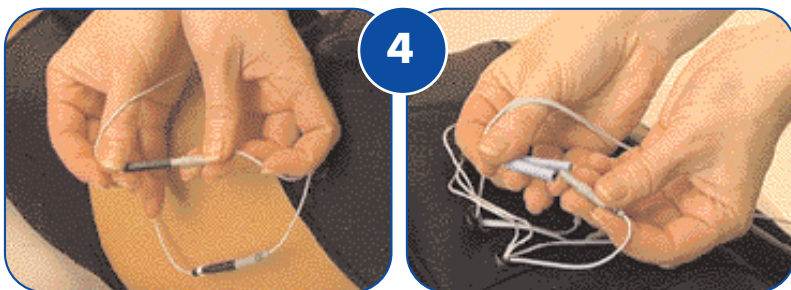
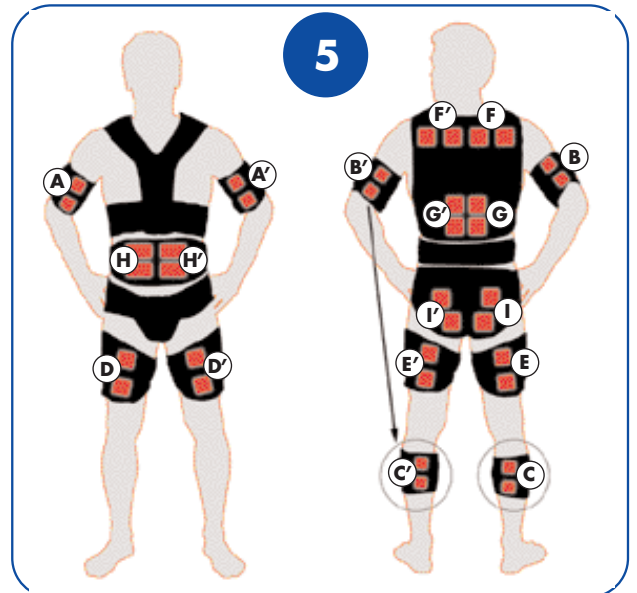
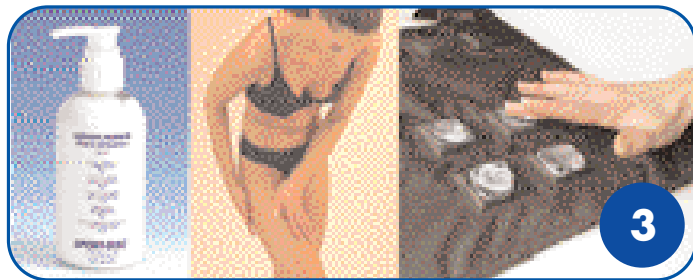
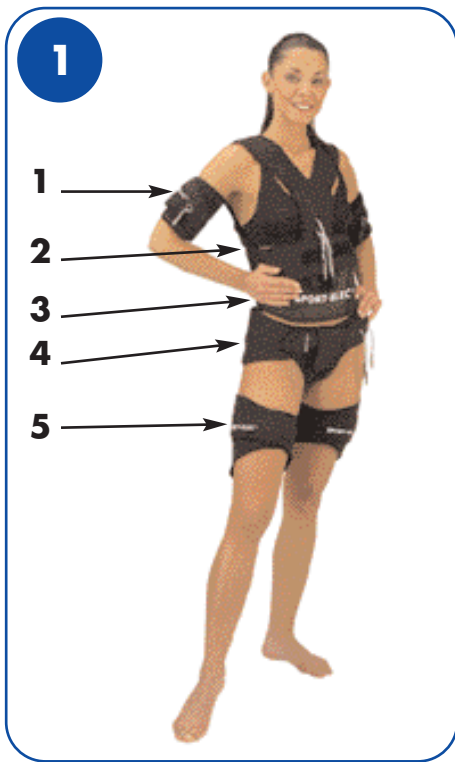

# INTRODUCTION

You have recently acquired a product designed and produced by **SPORT-ELEC**®. We thank you for your purchase and suggest that you read the instructions for use in this manual.

To make it easier to use your **SPORT-ELEC**® device or any other \* electro-bodybuilding device, **SPORT-ELEC**®, manufacturer of electro-body building devices for private and professional use, designed the COMBI.

This accessories kit includes 7 items of clothing with integrated electrodes making the placing of electrodes easier on the back and buttocks, but also on other muscular areas: abdominal muscles, thighs, arms.

The **COMBI** is supplied with est fourni avec 1 bottle of electro-conductive massage cream.

This improves comfort and makes electro-body building more effective.

(\* The **COMBI** may be adapted to all brands of electro-body building devices equipped with male plugs with a diameter of 2mm .

## I. PRESENTATION OF THE COMBI:

PHOTO 2, PAGE 1

### A) All COMBI clothing

Photo 1, page 1:

- 1 .2 Arm guards (or shin guards) with one pair of connections each
- 2 .1 Top with 4 pairs of connections
- 3 .1 Belt with 2 pairs of connections
4. 1 Short with 2 pairs of connections
5. 2 Cycle shorts with one pair of connections each

Location of the 24 integrated electrodes in carbon. (photo 5, page 1)

### B) Cosmetics: bottle of electro-conductive massage cream (Photo 3, page 1)

• **Properties:** massage-effect, electro-conductive

**List of ingredients of the "E1841" cream:** AQUA (WATER), CETEARYL ALCOHOL, CAPRYLIC/CAPRIC TRIGLYCERIDE, PARAFFINUM LIQUIDUM, DIMETHICONE, GLYCERINE, MENTHYL LACTATE, GLYCERYL STEARATE, CETEARETH-20, STEARIC ACID, METHYLPARABEN, PROPYLPARABEN, XANTHAN GUM, MENTHOL, CARBOMER, PARFUM, TOCOPHERYL ACETATE, BUTYLHYDROXYTOLUENE, TRIETHANOLAMINE, LAVANDULA HYBRIDA, CITRUS AURANTIUM, CITRUS NOBILIS, CITRUS RETICULATA, LINALOL, LIMONENE, GERANIOL.

• **Actions:** helps recovery after the effort

**List of ingredients of the "E1841" cream:** AQUA (WATER), CETEARYL ALCOHOL, CAPRYLIC/CAPRIC TRIGLYCERIDE, PARAFFINUM LIQUIDUM, SILOXANETRIOL ALGINATE CAFFEINE, GLYCERINE, DIMETHICONE, GLYCERYL STEARATE, CETEARETH-20, STEARIC ACID, METHYLPROPANEDIOL, METHYLPARABEN, PROPYLPARABEN, XANTHAN GUM, TOCOPHERYL ACETATE, BUTYLHYDROXYTOLUENE, CEDRUS ATLANTICA, CUPRESSUS SEMPERVIRENS, COPAIFERA OFFICINALIS, LITSEA CUBEBA, LAVANDULA STOECHAS, CITRUS RETICULATA, C.I.42090, LIMONENE, CITRAL, LINALOL

• **Actions:** helps lose weight

## II. USE OF THE COMBI:

After having applied the electro-conductive cream to the body and the electrodes (photo 3, page: 1), put on the clothing articles of your choice and connect to your electro-body building device.

Place the items of clothing corresponding to the selected muscular zone .

Use the velcro straps to adjust clothing.

Connect the clothing to the device. Always connect per pair (photo 4, page 1): 1 pair of connections (2 wires) on clothing connect to 1 pair of connections (2 wires) on the device.

- Black connections on the Combi concern right muscles.
- Grey connections on the Combi concern left muscles.(schema 6, 7, 8, page 1)

Attention! If your device has 3 wires, connect 2 wires of different colours to your COMBI connections (e.g. : BODY evolution)

## Table explaining schema 5, page 1

Connect the plugs on the device to:	You work:
<b>TOP</b> (schema 6 and 7, page1)	
Two black plugs 1 Two grey plugs 2 Two black plugs 3 Two grey plugs 4	Right trapeziuses (F) Left trapeziuses (F') Right back muscles (G) Left back muscles (G')
<b>SHORT</b> (schema 8, page 1)	
Two black plugs 1 Two grey plugs 2	Right buttocks (I) Left buttocks (I')
<b>BELT</b>	
Two black plugs 1 Two grey plugs 2	Right abdominal muscles (H) Left abdominal muscles (H)
<b>ARM GUARDS</b>	
Two black plugs 1  Two grey plugs 2	Right biceps (A) or right triceps (B) or right shin(C)  Left biceps (A') or left triceps (B') or left shin (C')
<b>CYCLE SHORTS</b>	
Two black plugs 1  Two grey plugs 2	right quadriceps (D) or right crural and semi-tendinous biceps (F)  left quadriceps (D') or left crural and semi-tendinous biceps (F')

### EXAMPLES OF THE USE OF THE COMBI WITH AN ELECTRO-BODYBUILDING DEVICE:

(see schema 5, page 1)

- If you have an electro-body building device with 2 generators  
(**SPORT-ELEC** @ type: Multi-sport complex, Body BEAUTIFUL, Evolution Body, Evolution Body Face, 6-beauty selection), you can work 2 muscular zones simultaneously and use either:
  - arms (biceps (A, A') or triceps (B, B')) using arm guards.
  - or shin muscles (internal and external pairs C, C') using the arm guards.
  - or abdominal muscles (H, H') using the belt
  - or buttocks (I, I') using the short.
  - or thighs (D, D' or E, E') using the cycle shorts.
  - or trapeziuses (F, F') using the top.
  - or back muscles (G, G') using the top.
  
- If you have an electro-body building device with 4 generators  
(type **SPORT-ELEC** @: Sport Pro, New Generation), you can work 4 muscular zones simultaneously, i.e.:
  - or trapeziuses (F, F') and back muscles (G, G') using the top.
  - or arms (A, A' or B, B') and thighs (D, D' or E, E') using arm guards and cycle shorts.
  - or abdominal muscles (H, H') and buttocks (I, I') using the belt and short.
  - or abdominal muscles (H, H') and buttocks (I, I') using the belt and cycle shorts.
  - or buttocks (H, H') and buttocks (I, I') using the short and cycle shorts.
  
- **Obviously you can try other connections with the COMBI according to the number of generators on your device.**

### III. TECHNICAL CHARACTERISTICS:

#### A) Clothing:

**Materials:** • Inner layer: 300 denier polyester  
• Outer layer: black polyester jersey (laminated on 2 mm EVA foam)  
**Size:** 34 - 52 for women and 36 - 60 for men  
**Electrodes:** carbon

#### B) Cream:

For all types of electro-body building devices (instead of gel) • Allows for manual massage • Electro-conductive massage cream.  
EC (76/768/EEC) COSMETICS

### IV. MAINTENANCE AND CLEANING INSTRUCTIONS:

Clean accessories with a humid sponge soaked with detergent and wipe with a cloth.

Clean electrodes with a mix of water and hypoallergenic detergent, and dry thoroughly.



- Do not machine wash or soak.
- Do not dry clean.
- Do not use bleach.

#### SAFETY CHECK:

Check the following once every 24 months:  
1- Check for superficial damage to equipment  
2- Check the reliability of accessories:  
• No tears • No latent defects.

#### Recommendations:

- When disposing of your product at end of life cycle, please comply with national regulations.  
Please dispose of the device in a location provided for this purpose in order to ensure safe and environmentally-friendly destruction.



#### PRECAUTIONS AND CONTRA-INDICATIONS:

Apply the precautions and contra-indications for the electro-bodybuilding device to which your COMBI will be attached

#### WARRANTY:

Accessories are intended for personal use.  
For hygiene reasons, they may not be refunded or exchanged

#### SURROUNDING CONDITIONS FOR TRANSPORT AND STORAGE:

- Air temperature of between +10°C and + 40°C
- Relative humidity of between 30% and 75%
- Pressure: 700 hPa.

### WARRANTY

The **SPORT-ELEC** ® is guaranteed for 2 years (components and labour time excluding cosmetics).

**SPORT-ELEC** ® accessories are for personal use and will not be refunded or exchanged.

**Should an item not function, specify the elements returned by ticking below:**

**I am returning:**

2 arm guards

Top

Belt

Short

2 cycle shorts

Send to **SPORT-ELEC S.A. - BP35 - Route de Rouen - 27520 BOURGTHEROULDE**

Date and location of purchase: .....

Full name: .....

Address: .....

.....

Telephone: .....

**IMPORTANT:** receipt or invoice must imperatively be enclosed

**Retailer's stamp**